

PROJECT BY: A.
BOROWIK, G. GLANZER,
B.RIZAEVA,
J.SONOKPON .
PRESENTED TO:
ANDREA PUKTERIS

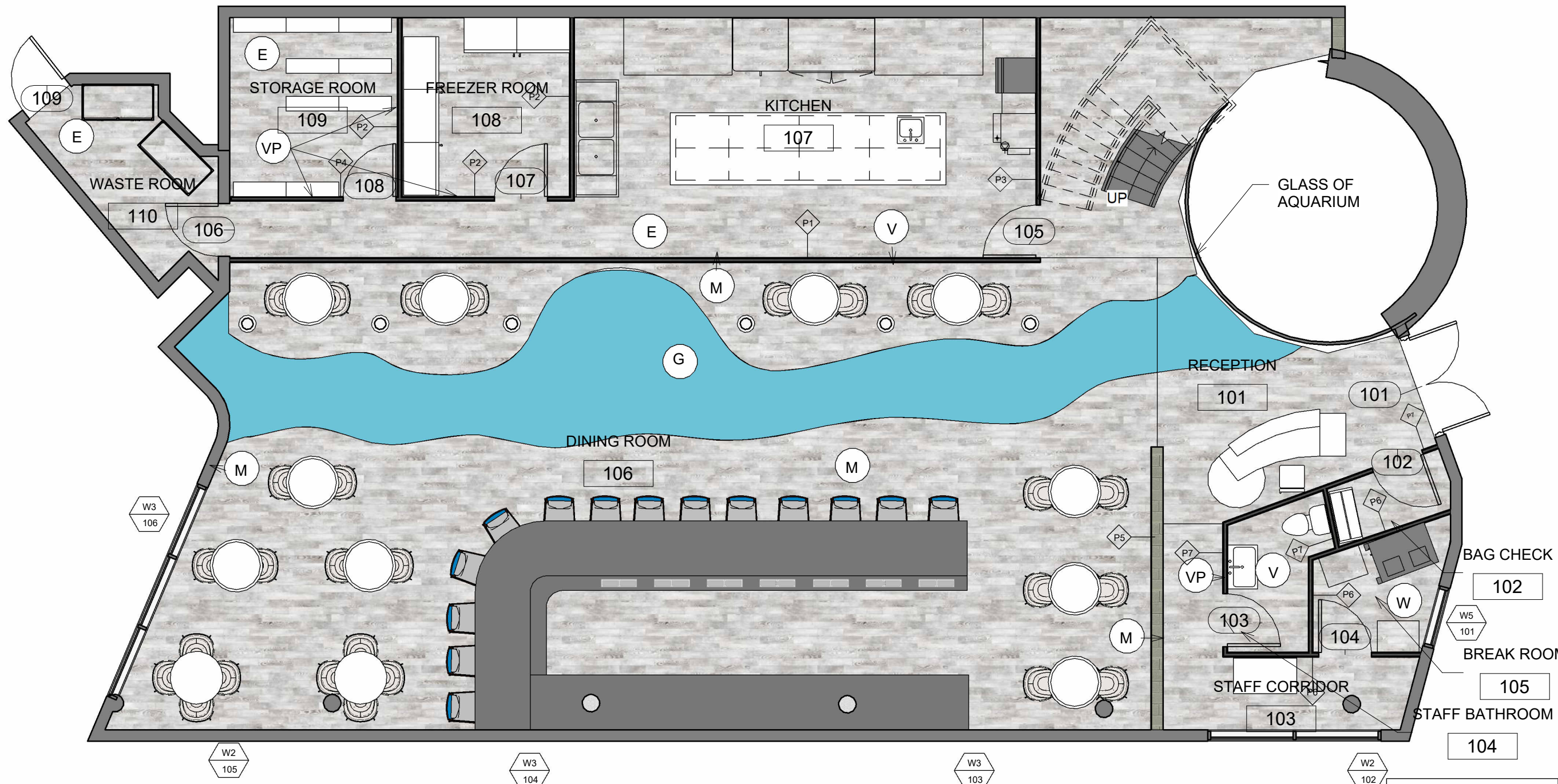

RESTAURANT
SIRÈNE BLEU





P1 - INTERIOR PARTITION TYPE 1
 - 5/8" SHEETROCK FIRECODE C CORE GYPSUM PANELS
 - 3 5/8" 25 GAUGE STEEL STUDS 24" O.C.
 - 3" SAFB
 - RESILIENT CHANNEL ONE SIDE SPACED 24" O.C.
 - VENEER PLASTER

P2 - INTERIOR PARTITION TYPE 2
 - 1/2" DUROCK CEMENT BOARD AND 1/4" CERAMIC TILE
 - 3 5/8" 20 GAUGE STEEL STUDS AT 16" O.C.
 - 3" SAFB
 - 5/8" SHEETROCK FIRECODE CORE GYPSUM PANELS, ONE SIDE

P3 - INTERIOR PARTITION TYPE 3
 - 5/8" SHEETROCK FIRECODE CORE GYPSUM PANELS ONE SIDE
 - 5/8" DURLOCK CEMENT BOARD
 - 3 1/2" 20 GAUGE STEEL STUDS 16" O.C.
 - 3" SAFB
 - CGC PLASTER BONDER OVER CEMENT BOARD AND TREATED JOINTS
 - FACE LAYER JOINTS TREATED WITH CGC SETTING-TYPE JOINT COMPOUND AND PAER TAPE
 - VENEER PLASTER

P4 - INTERIOR PARTITION TYPE 4
 - 3/4" SHEETROCK ULTRACODE CORE GYPSUM PANELS
 - 1 5/8" 25 GAUGE STEEL STUDS 24" O.C.
 - JOINTS FINISHED

P5 - INTERIOR PARTITION TYPE 5
 - 5/8" SHEETROCK FIRECODE CORE GYPSUM PANELS
 - 3 5/8" 25 GAUGE STEEL STUDS 24" O.C.
 - JOINTS FINISHED
 - VENEER PLASTER

P6 - INTERIOR PARTITION TYPE 6
 - 5/8" SHEETROCK FIRECODE CORE GYPSUM PANELS
 - 2 1/2" 25 GAUGE STEEL STUDS 24" O.C.
 - 2" MINERAL WOOL BATT IN CAVITY
 - JOINTS FINISHED

P7 - INTERIOR PARTITION TYPE 7
 - 1/2" SHEETROCK FIRECODE C CORE GYPSUM PANELS
 - 3 5/8" 20 GAUGE STEEL STUDS 24" O.C.
 - 3" SAFB
 - RESILIENT CHANNEL ONE SIDE SPACED 24" O.C.
 - 2 LAYERS GYPSUM PANELS
 - FACE LAYER JOINTS FINISHED
 - VENEER PLASTER

FINISHES LEGEND	
E	EPOXY
G	GLASS
M	MARBLE
W	WOOD
VP	VENEER PLASTER
V	VINYL

1 GROUND FLOOR PLAN
 1 : 75

RESTAURANT SIRÈNE BLEU
RENOVATION OF INTERIOR



No.	Description	Date

GROUND FLOOR PLAN	
Project number	0001
Date	27-11-2025
Drawn by	G.G., A.B., J.S., B.R.
Checked by	A.P.
A101	
Scale As indicated	

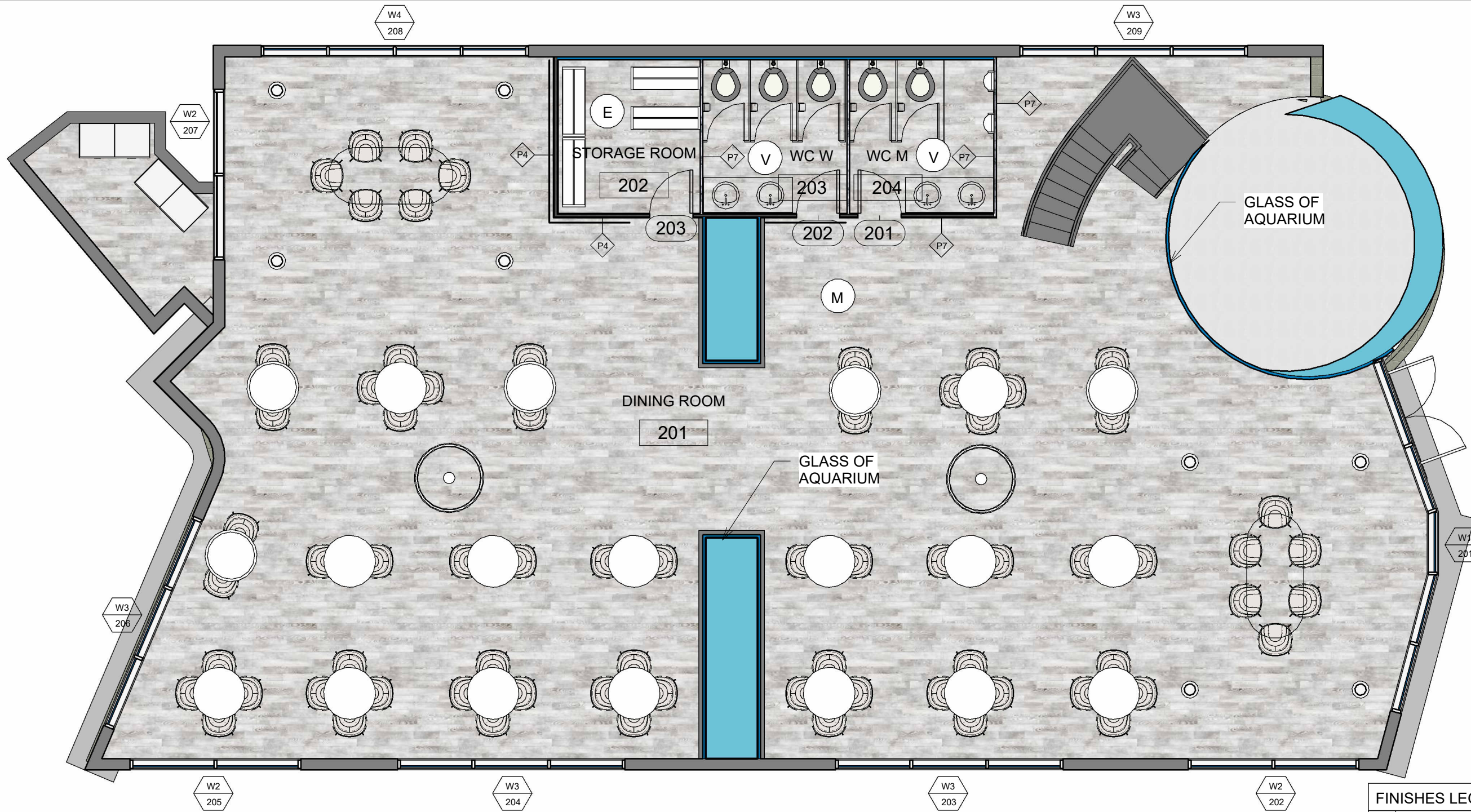

P1 - INTERIOR PARTITION TYPE 1
 - 5/8" SHEETROCK FIRECODE C CORE GYPSUM PANELS
 - 3 5/8" 25 GAUGE STEEL STUDS 24" O.C.
 - 3" SAFB
 - RESILIENT CHANNEL ONE SIDE SPACED 24" O.C.
 - VENEER PLASTER

P2 - INTERIOR PARTITION TYPE 2
 - 1/2" DUROCK CEMENT BOARD AND 1/4" CERAMIC TILE
 - 3 5/8" 20 GAUGE STEEL STUDS AT 16" O.C.
 - 3" SAFB
 - 5/8" SHEETROCK FIRECODE CORE GYPSUM PANELS, ONE SIDE

P3 - INTERIOR PARTITION TYPE 3
 - 5/8" SHEETROCK FIRECODE CORE GYPSUM PANELS ONE SIDE
 - 5/8" DURLOCK CEMENT BOARD
 - 3 1/2" 20 GAUGE STEEL STUDS 16" O.C.
 - 3" SAFB
 - CGC PLASTER BONDER OVER CEMENT BOARD AND TREATED JOINTS
 - FACE LAYER JOINTS TREATED WITH CGC SETTING-TYPE JOINT COMPOUND AND PAER TAPE
 - VENEER PLASTER

P4 - INTERIOR PARTITION TYPE 4
 - 3/4" SHEETROCK ULTRACODE CORE GYPSUM PANELS
 - 1 5/8" 25 GAUGE STUDS 24" O.C.
 - JOINTS FINISHED

P5 - INTERIOR PARTITION TYPE 5
 - 5/8" SHEETROCK FIRECODE CORE GYPSUM PANELS
 - 3 5/8" 25 GAUGE STEEL STUDS 24" O.C.
 - JOINTS FINISHED
 - VENEER PLASTER

P6 - INTERIOR PARTITION TYPE 6
 - 5/8" SHEETROCK FIRECODE CORE GYPSUM PANELS
 - 2 1/2" 25 GAUGE STEEL STUDS 24" O.C.
 - 2" MINERAL WOOL BATT IN CAVITY
 - JOINTS FINISHED

P7 - INTERIOR PARTITION TYPE 7
 - 1/2" SHEETROCK FIRECODE C CORE GYPSUM PANELS
 - 3 5/8" 20 GAUGE STUDS 24" O.C.
 - 3" SAFB
 - RESILIENT CHANNEL ONE SIDE SPACED 24" O.C.
 - 2 LAYERS GYPSUM PANELS
 - FACE LAYER JOINTS FINISHED
 - VENEER PLASTER

FINISHES LEGEND	
E	EPOXY
G	GLASS
M	MARBLE
W	WOOD
VP	VENEER PLASTER
V	VINYL

1 SECOND FLOOR PLAN
 1 : 75

RESTAURANT SIRÈNE BLEU
RENOVATION OF INTERIOR



No.	Description	Date

SECOND FLOOR PLAN	
Project number	0001
Date	27-11-2025
Drawn by	G.G., A.B., J.S., B.R.
Checked by	A.P.
A102	
Scale As indicated	